

Alcances generales:

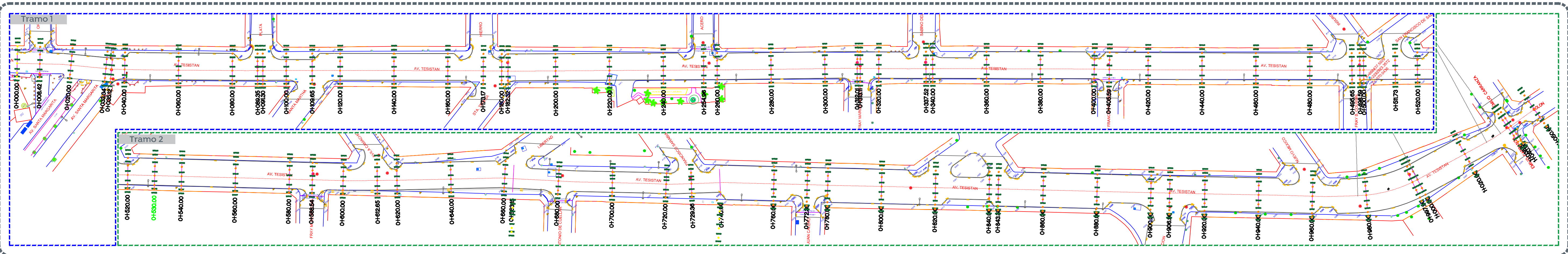

Planta general Escala 1:750

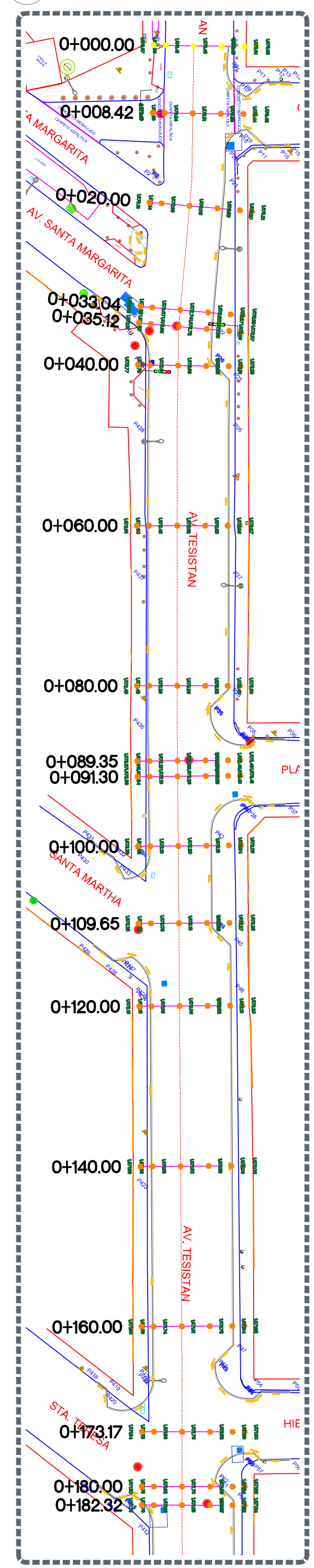

1 Planta Escala 1:450

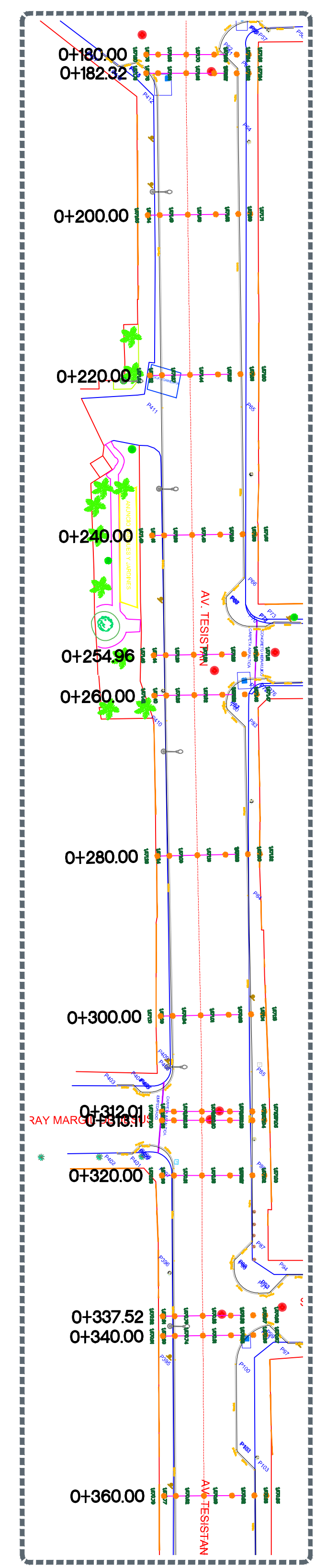

2 Planta Escala 1:450

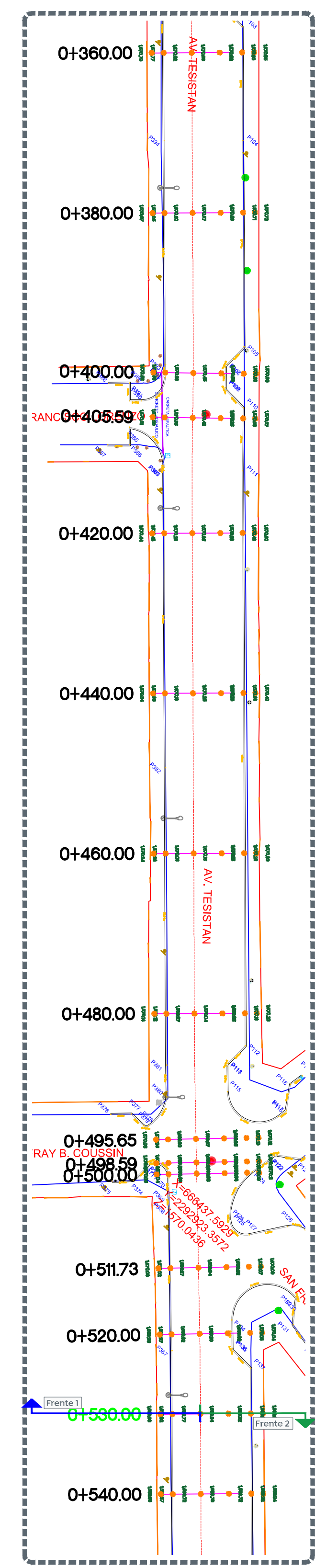

3 Planta Escala 1:450

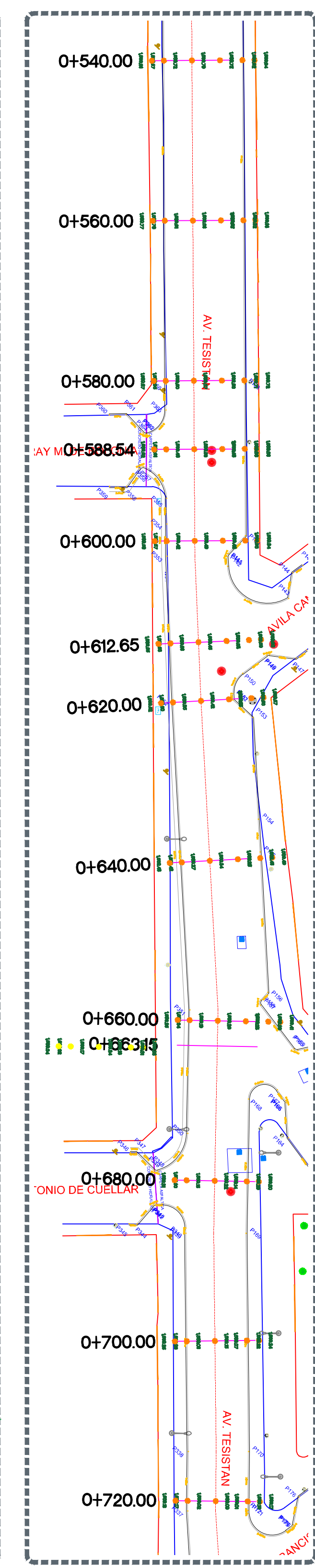

4 Planta Escala 1:450

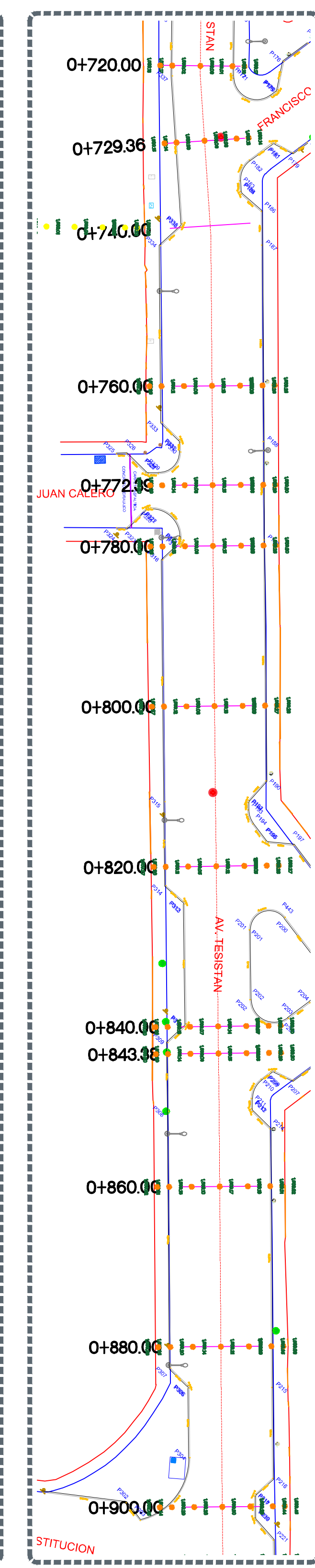

5 Planta Escala 1:450

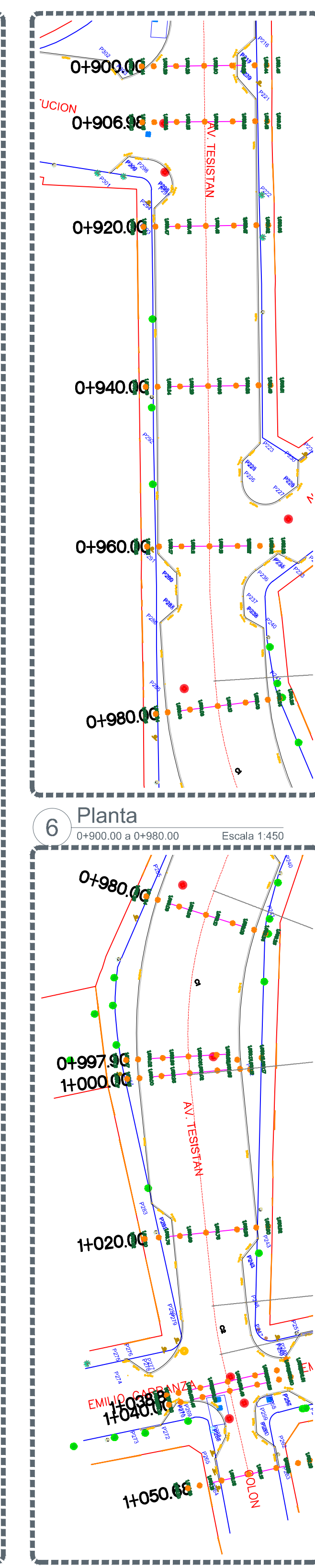

6 Planta Escala 1:450

CUADRO DE CONSTRUCCION DE EJE						
EST	LADO	PV	RUMBO	DISTANCIA	V	COORDENADAS
						X Y
PST-0+000.00		PH-0+016.85	S 42°41'17.78" E	16.860	PH-0+016.85	666,094,3693 2,293,289,7217
PH-0+016.85		PH-0+035.58	S 38°27'35.96" E Δ = 419'41.82" der	18.621	PH-0+035.58	666,105,7925 2,293,277,3288
PH-0+035.58		PH-0+047.69	S 42°38'12.80" E Δ = 410'38.84" lq	12.317	PH-0+047.69	666,125,6550 2,293,253,7649
PH-0+047.69		PH-0+084.68	S 43°31'44.07" E Δ = 0'53'31.27" lq	36.984	PH-0+084.68	666,151,1285 2,293,226,9507
PH-0+084.68		PH-0+101.48	S 44°05'18.87" E Δ = 0'33'34.80" lq	18.803	PH-0+101.48	666,162,8777 2,293,214,8814
PH-0+101.48		PH-0+166.51	S 43°59'38.45" E Δ = 0'9'40.43" der	65.027	PH-0+166.51	666,207,9299 2,293,168,0477
PH-0+166.51		PH-0+188.06	S 43°28'57.57" E Δ = 0'27'0.88" der	18.550	PH-0+188.06	666,220,8935 2,293,154,5868
PH-0+188.06		PH-0+263.14	S 44°19'22.47" E Δ = 0'48'44.84" lq	78.088	PH-0+263.14	666,275,2372 2,293,098,7060
PH-0+263.14		PH-0+307.12	S 44°41'22.84" E Δ = 0'23'0.43" der	43.978	PH-0+307.12	666,308,1644 2,293,067,4420
PH-0+307.12		PH-0+330.64	S 43°37'01.77" E Δ = 14'21.07" der	23.522	PH-0+330.64	666,322,8906 2,293,050,4190
PH-0+330.64		PH-0+343.01	S 44°08'37.74" E Δ = 0'31'35.97" lq	12.368	PH-0+343.01	666,331,0046 2,293,041,5376
PH-0+343.01		PH-0+398.97	S 42°44'38.34" E Δ = 18'27.92" der	55.963	PH-0+398.97	666,369,7755 2,293,001,8707
PH-0+398.97		PH-0+412.20	S 43°47'01.19" E Δ = 12'22.81" lq	13.222	PH-0+412.20	666,378,7493 2,292,991,4708
PH-0+412.20		PH-0+486.41	S 44°38'16.68" E Δ = 0'49'14.54" lq	74.212	PH-0+486.41	666,430,0995 2,292,937,8928
PH-0+486.41		PH-0+522.06	S 43°52'03.93" E Δ = 0'44'17.6" der	36.655	PH-0+522.06	666,456,1368 2,292,912,5073
PH-0+522.06		PH-0+601.84	S 45°55'53.62" E Δ = 2'3'49.60" lq	79.780	PH-0+601.84	666,510,4238 2,292,854,9008
PH-0+601.84		PH-0+698.69	S 46°40'21.35" E Δ = 0'44'27.73" der	17.843	PH-0+698.69	666,523,2444 2,292,842,9805
PH-0+698.69		PH-0+698.69	S 45°55'53.62" E Δ = 2'3'49.60" lq	38.897	PH-0+698.69	666,551,6369 2,292,816,8006
PH-0+698.69		PH-0+698.69	S 42°28'27.01" E Δ = 419'54.94" der	27.976	PH-0+698.69	666,570,4188 2,292,795,2451
PH-0+698.69		PH-0+713.82	S 44°18'19.19" E Δ = 143'52.18" lq	27.265	PH-0+713.82	666,586,4173 2,292,775,9894
PH-0+713.82		PH-0+721.22	S 42°55'36.74" E Δ = 1'14'43.45" der	7.399	PH-0+721.22	666,594,4562 2,292,770,2720
PH-0+721.22		PH-0+741.25	S 47°18'16.45" E Δ = 4'22'40.73" der	20.031	PH-0+741.25	666,608,1785 2,292,756,8888
PH-0+741.25		PH-0+767.02	S 43°58'47.82" E Δ = 3'19'28.64" der	25.763	PH-0+767.02	666,627,0688 2,292,738,1499
PH-0+767.02		PH-0+779.32	S 43°48'10.62" E Δ = 0'10'37.20" der	12.307	PH-0+779.32	666,635,5676 2,292,729,2675
PH-0+779.32		PH-0+811.90	S 44°04'55.96" E Δ = 0'18'45.34" der	32.860	PH-0+811.90	666,658,2530 2,292,705,8940
PH-0+811.90		PH-0+850.55	S 44°12'33.22" E Δ = 0'7'37.28" lq	38.644	PH-0+850.55	666,688,1985 2,292,678,1644
PH-0+850.55		PH-0+885.15	S 43°56'44.68" E Δ = 0'18'48.95" der	34.802	PH-0+885.15	666,709,2116 2,292,663,2608
PH-0+885.15		PH-0+916.81	S 44°04'44.07" E Δ = 0'7'59.42" lq	30.655	PH-0+916.81	666,730,5369 2,292,631,2286
PH-0+916.81		PH-0+946.42	S 44°19'33.84" E Δ = 0'14'46.78" lq	30.812	PH-0+946.42	666,751,9271 2,292,609,3292
PH-0+946.42		PH-0+966.65	S 43°53'30.62" E Δ = 0'26'3.22" der	19.238	PH-0+966.65	666,765,2637 2,292,595,4665
PH-0+966.65		PST-H+050.68	S 66°14'51.19" E Δ = 24'21'20.49" lq	83.255	PST-H+050.68	666,842,5906 2,292,564,8123

LONGITUD = 1,050.681m

CUADRO DE CURVAS HORIZONTALES						
CURVA	DELTA	RADIO	ARCO	STAN	CUERDA	AREA BAJO CUERDA
C1	26°44'8.47"	50.000	23.331	11.882	23.120	20.938
C2	07°52'10"	50.000	6.121	3.064	6.117	0.382

**Simbología**

- 0+000.00 Cadenamientos @ 20 m
- Eje geométrico
- 1.632.08 Rasante
- 0.42 Cota trazo
- P164 Punto de cuadro de construcción

Fronte 1 Fronte 2

Nombre del proyecto:  
 Pavimentación con concreto hidráulico de la Av. Tesisstan, frente 01, incluye: alcantarillado sanitario, agua potable, banquetas, cruces peatonales, accesibilidad universal, señalética horizontal - vertical y obras complementarias, colonias San Francisco, San José del Bajío, Santa Margarita Ira. Sección, Centro, San Isidro ejidal, la Villa, Municipio de Zapopan, Jalisco

Contenido del plano:  
 Planta gra., Cuadro de construcción de eje.

No. Contrato:  
 DOPI-MUN-PP-PAV-LP-079-2022

Director de Obras Públicas e Infraestructura:  
 Ing. Ismael Jáuregui Castañeda

Jefe de la Unidad de Estudios y Proyectos:  
 Arq. Edwin Aguilar Escatet

Jefe de área:  
 Inar. Norberto Esaú Romero Joya

Responsable del proyecto:  
 Inar. Norberto Esaú Romero Joya

Ubicación:  
 Col. San Francisco, Zapopan, Jalisco

Norte: Fecha: junio 2022  
 Escala: Indicada  
 Acotaciones: Metros

Clave: GEO-01